

# Where's my next lesson?

## **The School Map**

One of the most intimidating parts of starting a new school is the size of it. There are so many different rooms for different subjects in different buildings. But this will all come natural to you.

We have 3 buildings here on site: the **Main Building**, the **Jubilee Block** and the **Technology Block**.

## **A little bit of history...**

In 1914, St. Julian's School was built as two separate boy's and girl's schools, with the boys on one side and the girls on the other.

Therefore, the Main Building is made up of two sides; the WEST side and EAST side which are a mirror of each other.

This may seem confusing at first, but you'll get the hang of it!

"... Once you get used to it, you realise it's actually not that hard!"

"I was so worried about getting lost! ... I kept asking the teachers for help"

# Main Building

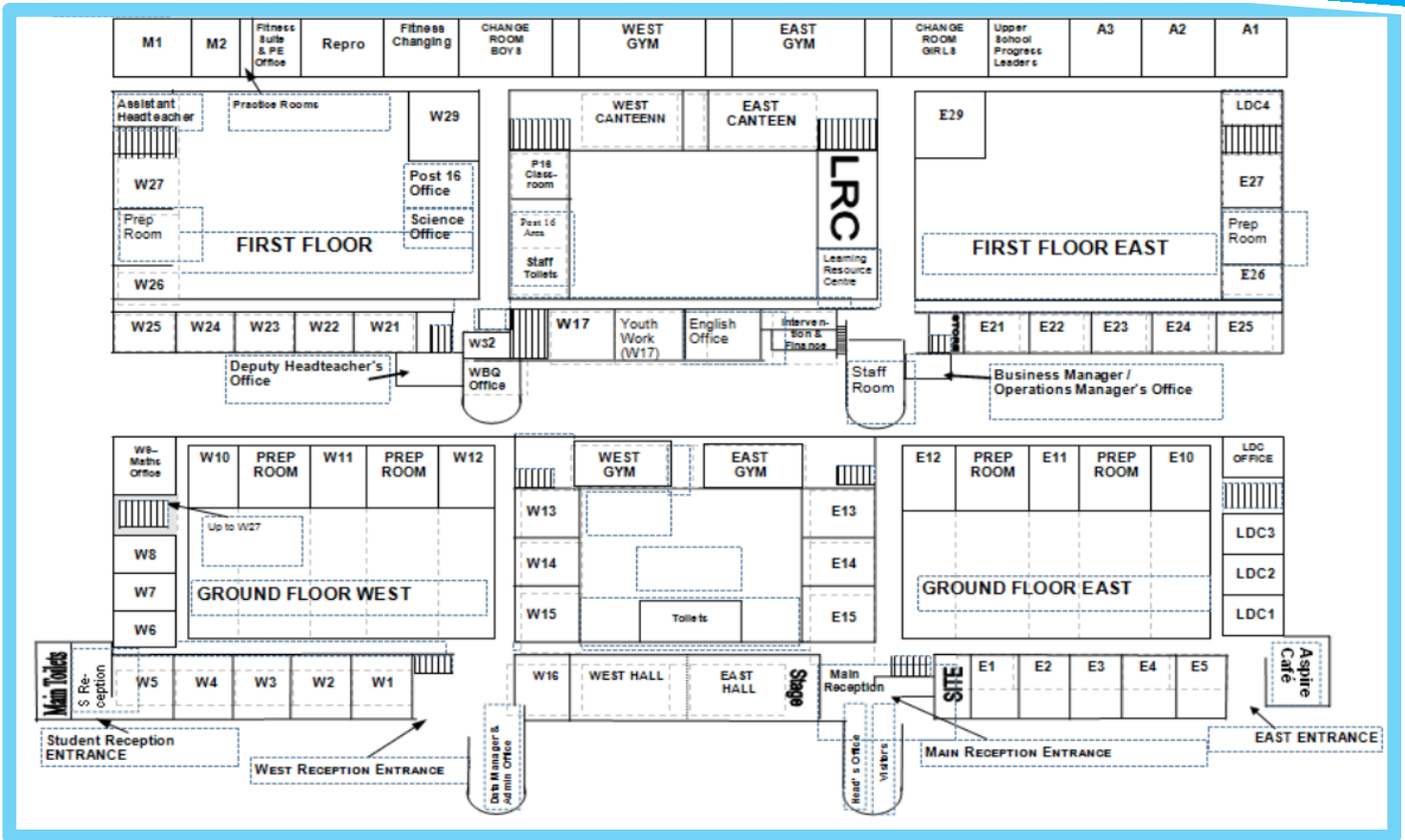

# Jubilee / Tech Blocks

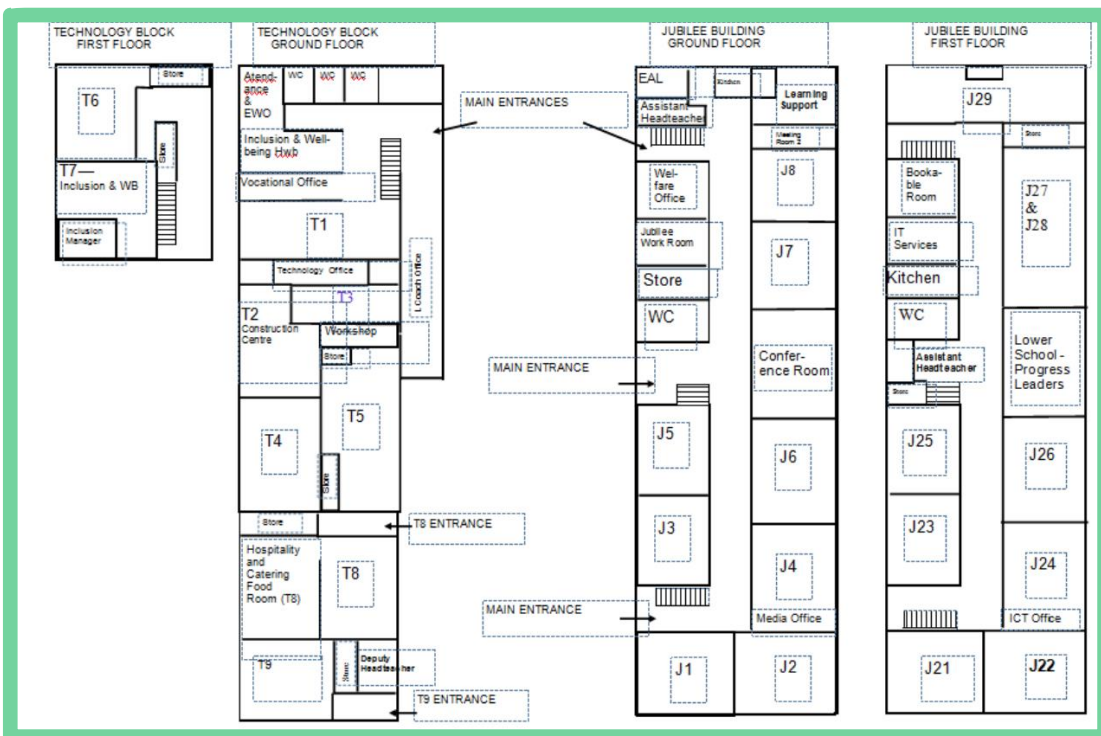

"Just think of it as J for Jubilee, T is for Tech, E is for East and W is for West"